

2005 Spec. Refinery Expansion

- ▶ Client: Motor Oil Hellas(MOH), Corinth Refineries S.A., Greece
- ▶ Engineering Services – Construction Supervision – Local Materials
- ▶ Production: 65,000 Nm³/h Hydrogen, 200 Tn/h Naftha from Mild Hydrocraker.
- ▶ July 2003 – October 2005

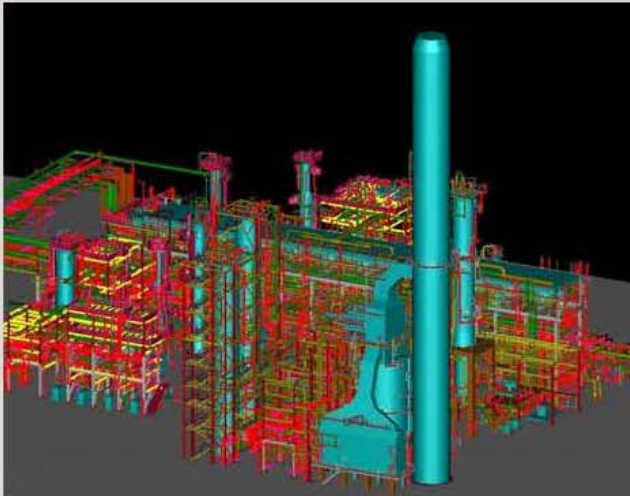

ATPL main involvement was the engineering (civil / piping / instrument / electrical / stress analysis / mechanical) of new and revamped units as follows:

- CDU (Revamping)
- Debut. / Deethan. Unit (Revamping)
- Diesel unit (Revamping)
- Vacuum Unit (Revamping)
- Tail gas Treatment Unit (Revamping)
- Desalination Unit (New)
- Cooling Tower Unit (New)
- Utilities Units (New)
- New GT4 in the refinery power plant